

CUTTING AND INSTALLATION OF RINGS

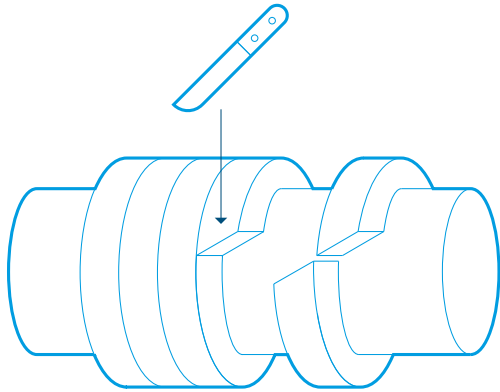

STEP 1: Cutting Packing at 45° angle

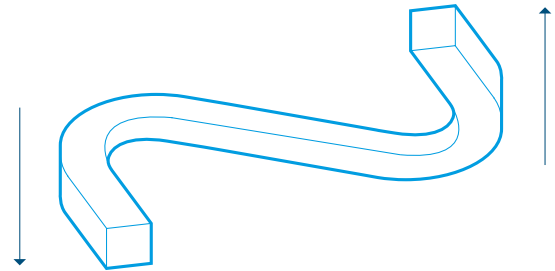

STEP 2: First open axially, then radially

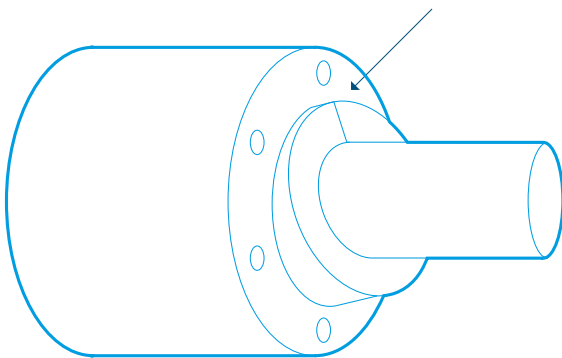

STEP 3: Introduce the joint end first

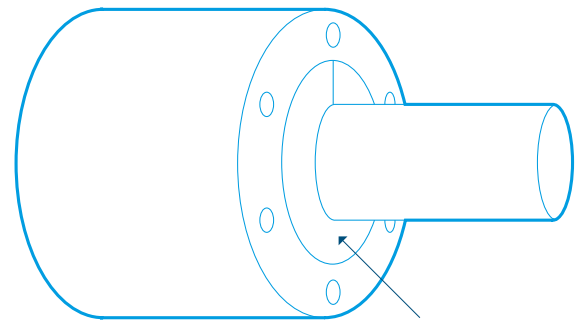

STEP 4: Push packings into place

STUFFING BOX DETAILS

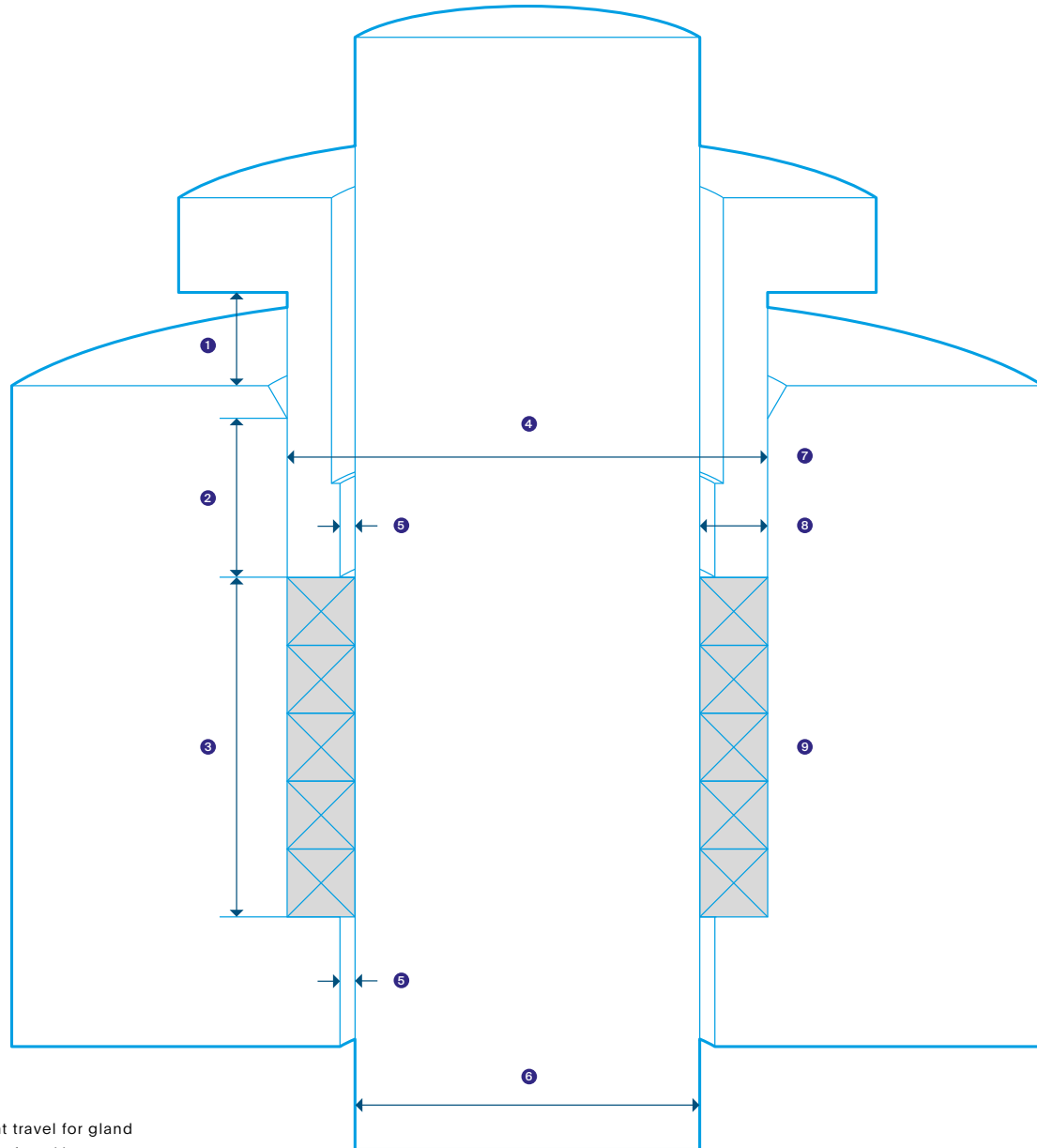

- ❶ Adjustment travel for gland
20 to 30 % of packing set
height
- ❷ Min. insert depth for gland
 $0.5 \times$ packing width
- ❸ Packing set height
- ❹ Housing diameter
- ❺ Clearance max. $0.02 \times$
packing width
- ❻ Stem / Shaft diameter
- ❼ Chamfer $2 \times 30^\circ$
- ❽ Packing width
- ❾ Stuffing box packing